

USER MANUAL



XZENT

X-527



2-Din Infotainer X-527

ABOUT THIS MANUAL

This manual contains important information and warnings about the operation of this XZENT unit. Please store it in a place where you have access later on.

SAFTY INFORMATION	3
FRONT PANEL KEYS	4
MAIN MENU	5
APPS	6 - 7
MAIN MENU TOUCH OPERATIONS AND NAVIGATION	8 - 9
GOOGLE ANDROID AUTO	10
APPLE CARPLAY	11
(MAIN SYSTEM) SETTINGS	12 - 13
RADIO TUNER	14
DAB TUNER	15
USB AUDIO	16
USB VIDEO	17
AUX-IN / HDMI	18
CAMERA	19
BLUETOOTH PHONE	20 - 21
BLUETOOTH MUSIC STREAMING	22
WIRING DIAGRAM	23
TECHNICAL SPECIFICATIONS	24
ADDITIONAL INFORMATIONS	25

Note

1. The descriptions and other content shown in this manual may deviate from the real device.
 2. Pictures shown in this manual and some HMI screenshots may deviate from the real unit.
 3. Specifications and technical design of this device model are necessarily subject to change without notice.
- Read the instructions entirely. Heed all warnings. Follow the instructions.
 - Retain this manual. Whoever will use the unit should have access to this manual.
 - This unit is designed to be functional in vehicles with 12 V DC battery and negative ground.
 - Do not operate the unit in any other way than described in this manual. Failure to follow the instructions as provided may void your warranty.
 - Do not disassemble or alter the unit in any way because this will void your warranty. Do not Attempt to repair or to service the unit yourself, but contact an authorized XZENT dealer instead.
 - Use only original accessories which are designed and manufactured for the unit, otherwise you will risk damage. Install the unit according to the mounting instructions by using the supplied mounting accessories. Acceleration forces during accidents can be huge. Incorrectly mounted devices pose a serious risk for the driver and passengers during an accident.
 - Protect the unit from water and other liquids that could enter the housing. A short circuit or even a fire could result.
 - To prevent a short circuit, never insert any metallic object (such as coins or metal tools) into the unit.
 - Before you replace a defective fuse try to find the cause for the short circuit. Pay attention to the cables of the power supply! If the short circuit does not result from a failure of the power supply or wiring, you can replace the defective fuse with a new one (of identical value). If the shortcircuit persists, contact an authorized XZENT dealer.
 - When connecting to any other device, read the user's guide for compatibility and notes on electrical connections. Do not try to connect incompatible products.
 - Be careful not to drain the car battery while using the unit when the car engine is turned off. Because the unit consumes a considerable amount of energy and the battery will be charged only while the engine is running, it might happen that the battery will discharge to a point where it is not possible to start the engine anymore.
 - According to the law in different European countries, driving with monitors showing movies in the viewing range of the driver is not allowed, because the driver might get distracted from traffic. Please respect the traffic regulations of your country or you may face legal penalties in case of accidents or even lose your insurance coverage. Pay attention to the playback volume inside your vehicle since you are required to notice exterior warning sounds like police sirens etc..
 - Don't expose the unit to hard impacts. A mechanical or electrical malfunction of the unit could be the result.
 - Should any problems or questions occur during the installation, please consult your XZENT dealer/importer.

X-527 FRONT PANEL KEYS



Operation Buttons/ touch-area Buttons:

- | | |
|-----------------|--|
| 1. Reset | Press to perform a power reset. |
| 2. Home | Press to enter Main Menu. |
| 3. FAV | Press to enter your favourite source.
You can set the FAV source in Settings, General menu. |
| 4. Power/Volume | When on, rotate to adjust Volume, press to MUTE.
Press and hold to enter Standby (Screen Off, Audio Off). |
| 5. Voice | Press to start voice recognition (in use with Android Auto or CarPlay). |
| 6. CAM | Press to enter rear camera view, press again to exit. |
| 7. Touch area | Press screen area to perform touch press action. |

Various:

- | | |
|---|------------|
| A | Microphone |
|---|------------|

MAIN MENU



MAIN MENU Operation area

- | | |
|-------------------|--|
| 1. Top section | Home Icon: Press in other sources to return to this page.
Return arrow: Press to go back 1 level
3 Dot icon: Press to select different background
Tap and drag the top bar area to show control center*.

Next to the clock in corner you can find Bluetooth status Icons and signal. You can see an operation example of dragging down the control center following up in this chapter.

Control Center*
Allows you to quick access specific system functions for Display settings, Screenshots, Volume, Clear Source memory ect. |
| 1. Middle section | The left side of the middle sections shows the current active audio source. Depending on the audio source additional data and play/pause status is shown. Press the area to show active source in full screen mode. On the right side of the middle section you can see a large clock and calendar area. Press it to adjust clock and date settings. |
| 1. Lower section | The lower section contains 4 pcs quick source selections. By default this is FM/AM, (USB) Music, BT Telephony, and Settings.
You can hold and drag one source icon to the upper delete section to remove it from quick area. Select then from the ALL-Sources pages a new source to put it to the free quick source spot. You can see an operation example of delete and add following up in this chapter.. |

This is the start screen section for quick access.

Swipe this screen away to the left to see the additional pages with all available sources ((see next page). You can see an operation example of swiping following up in this chapter

APPS

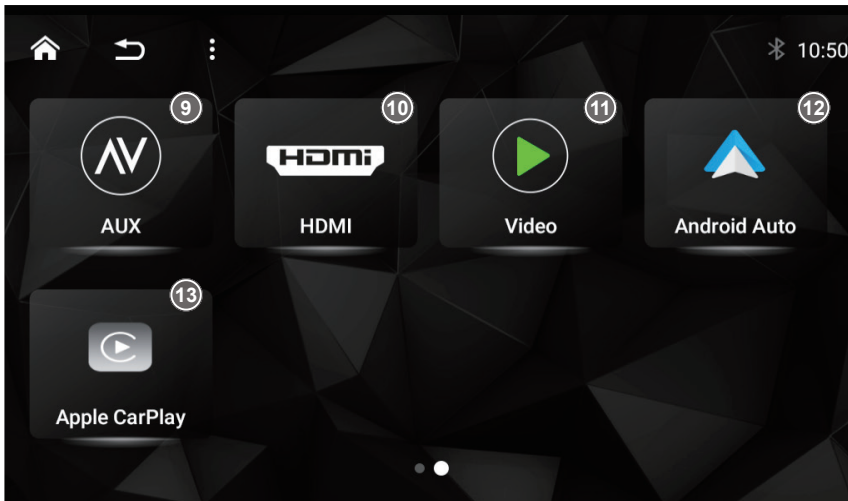
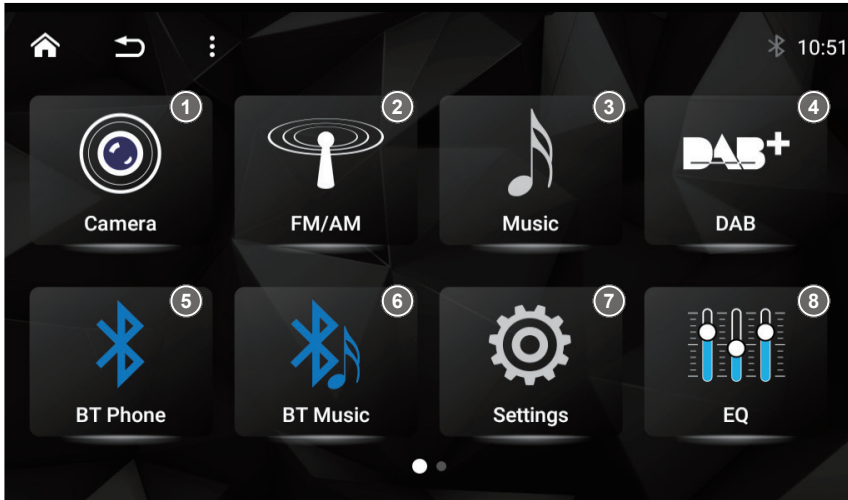

after removing a quick source icon from lower section of the start screen, you can drag and drop a new Icon from this page to the free spot of the lower section. See operation example following up in this chapter.

APPs Operation buttons and area

- | | |
|-------------------|-------------------------------|
| 1. Camera | Tap to enter Camera source |
| 2. FM / AM | Tap to enter FM/AM source |
| 3. Music | Tap to enter Music source |
| 4. DAB | Tap to enter DAB source |
| 5. BT Phone | Tap to enter BT Phone source. |
| 6. BT Music | Tap to enter BT Music source |
| 7. Settings | Tap to enter Settings |
| 8. EQ | Tap to enter EQ |
| 9. AUX | Tap to enter AUX source |
| 10. HDMI | Tap to enter HDMI source |
| 11. Video | Tap to enter Videosource |
| 12. Android Auto | Tap to enter Android Auto |
| 13. Apple CarPlay | Tap to enter Apple CarPlay |

MAIN MENU Touch operation examples

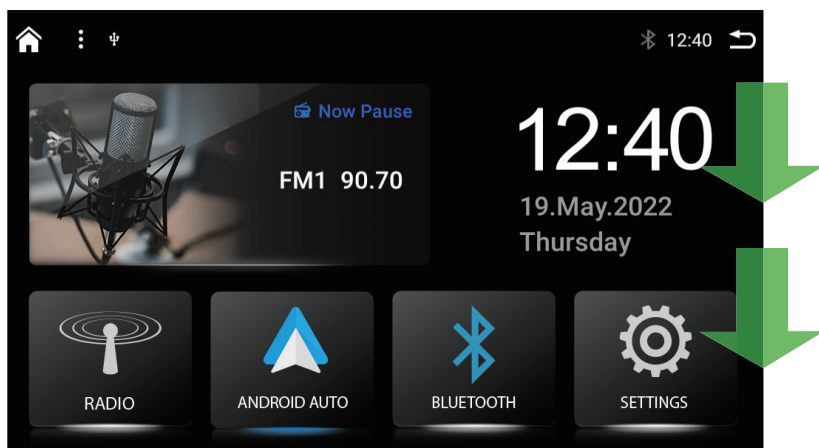

You can access the quick menu by swiping downwards. Many settings can be quickly accessed through the quick menu, such as the brightness of the screen.

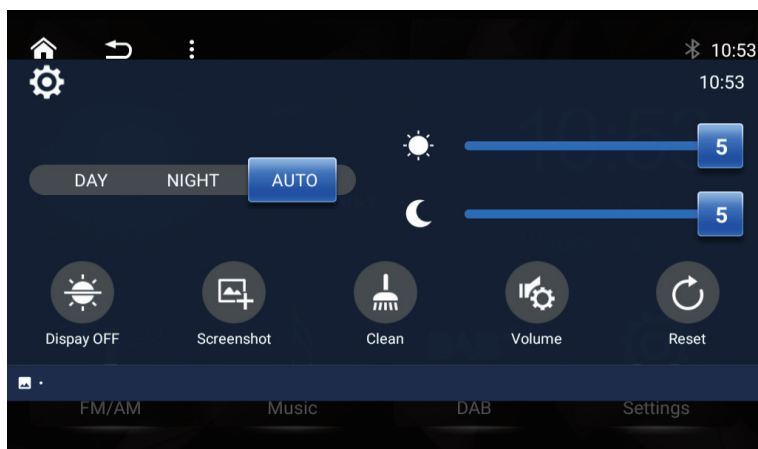

MAIN MENU NAVIGATION

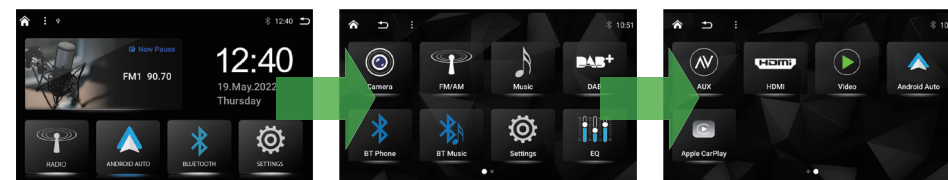

You can navigate the home screen by swiping left or right.

APP ICON CHANGE

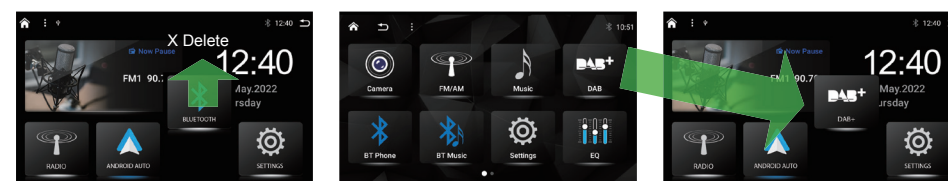

First you need to make place for the new icon and delete one. Then by pressing and holding the app icon, the app icon can be pinned to the home screen.

GOOGLE ANDROID AUTO

With Google Android Auto, you are able to access compatible apps and online services of your Android smartphone in your car and operate them intuitively with the display of your XZENT device or the voice assistant from Google.

PREPARATION:

- Download the Android Auto app from the Google Play Store (for OS Android 9 and below). On higher OS preinstalled..
- Connect the Android smartphone with the CP/AA USB connector of the XZENT device.
- Bluetooth will be automatically establish on USB first time connection.

INITIAL OPERATION:

1. For the initial operation, the vehicle must not be in motion and the hand brake must be put on.
2. Tap to the Android Auto icon in the main menu of the XZENT device to choose the Android Auto source.
3. Follow the dialogue on the display of your smartphone to install Android Auto and to configure the start behaviour. It is possible to change the selected start behaviour in the setup operations anytime later.
4. After the initial operation has been completed successfully, the Android Auto user interface appears on the screen of the XZENT device.

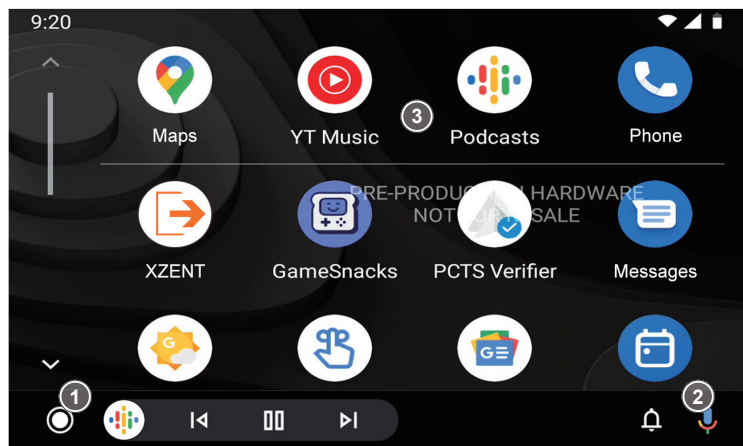

1. Tap to display the home screen of Android Auto main.
2. Tap to activate Android Auto voice control.
3. Tap any of the APP icon to start the application.
XZENT: Tap to open XZENT main menu.

Note:

- Android Auto may not be available on all devices and is not available in all countries and regions.
- To use Android Auto with your Android Smartphone, at least Android 5.0 (Lollipop) or a higher version of the Android operation system must be installed on your smartphone.
- For more detailed information about Android Auto, please visit <https://www.android.com/auto/> and <https://support.google.com/androidauto#topic=6348027>

APPLE CARPLAY

With Apple CarPlay, you are able to access compatible apps and online services of your iPhone in your car and operate them intuitively with the display of your XZENT device or the voice assistant from Apple.

PREPARATION:

- Connect the compatible iPhone with the CP/AA USB connector of the XZENT device.
- Bluetooth will be automatically establish on USB first time connection.
- Unlock your iPhone.

INITIAL OPERATION:

1. For the initial operation, the vehicle must not be in motion and the hand brake must be put on.
2. Tap to the CarPlay icon in the main menu of the XZENT device to choose the CarPlay source. After the initial operation has been completed successfully, the CarPlay user interface appears on the screen of the XZENT.

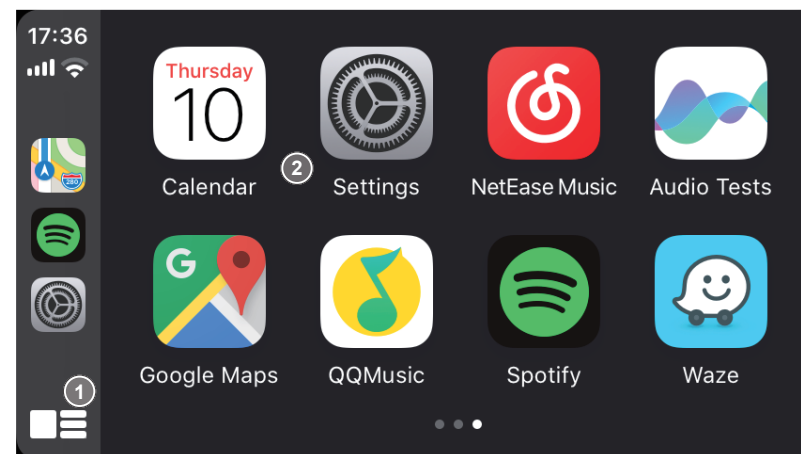

1. Tap to display the home screen of CarPlay.
2. Tap any of the APP icon to start the application.

(MAIN SYSTEM) SETTINGS

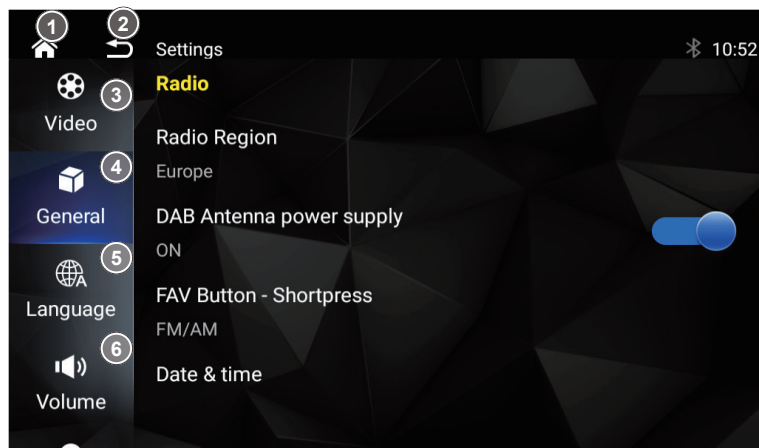

Operation buttons

- | | |
|-------------|---|
| 1. Home | Tap to open Main Menu. |
| 2. Back | Tap to return to previous menu. |
| 3. Video | Tap to show list:
Back Camera: Tap to select Normal/Mirroring mode
Camera Mute: ON/OFF
Camera Distance Line: ON/OFF |
| 4. General | Tap to show list:
Beep: ON/OFF
Link USB devices, Auto Play Music: ON/OFF
Radio Region: Select an area in the list.
DAB Antenna power supply: ON/OFF
FAV Button - Shortpress: Tap to select your Favourite source.
Date & Time: tap to set the Date and Time |
| 5. Language | Tap to select a different available language. |
| 6. Volume | Tap bar of the source gain to change gain of the specific source. |

(MAIN SYSTEM) SETTINGS

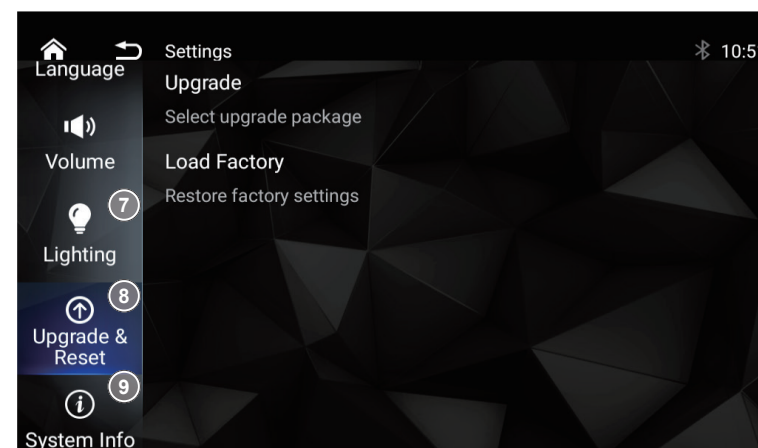

- | | |
|--------------------|---|
| 7. Lighting | Tap to show Key Light setting menu.
Press the light bulb to toggle fix or random color.
You can select a fix color by selecting directly on the color plate, or use the RGB bars or select a preset color from the shown rectangles with color. |
| 8. Upgrade & Reset | Upgrade: Tap to enter upgrade menu.
Factory reset: Tap to reset device to factory / default settings. |
| 9. System Info | Display current software version. |

FM / AM

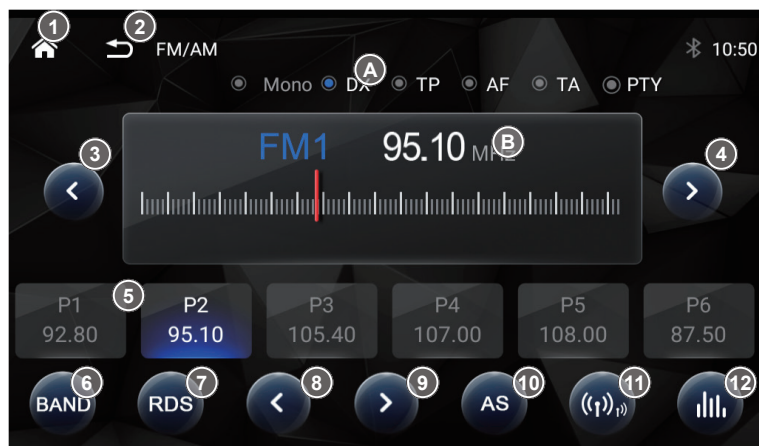

Operation buttons

- | | |
|----------------|--|
| 1. Home | Tap to open Main Menu. |
| 2. Back | Tap to return. |
| 3. Seek Down | Tap to step frequency down.
Tap and hold to seek down. |
| 4. Seek Up | Tap to step frequency up.
Tap and hold to seek up. |
| 5. Preset | Tap to select preset.
Tap and hold to save current station as preset. |
| 6. BAND | Tap to switch the Radio band. |
| 7. RDS | Tap to turn on/off RDS. |
| 8. Preset Down | Tap to select previous preset station. |
| 9. Preset Up | Tap to select next preset station. |
| 10. Auto store | Tap to search and auto save all presets. |
| 11. LOC/DX | Tap to receive Local/Distant Radio signals. |
| 12. EQ | Tap to open EQ menu. |

- | | |
|---|---|
| A | Information display fields for tuner settings and RDS features. |
| B | Current station frequency (or RDS station name). |

Note:

- This unit features an RDS tuner. RDS is a system which transmits data on top of the radio signal. Availability and content of the RDS data depend on the respective broadcast station and its signal strength. RDS does, for example, transmit alternative frequencies, which allow for frequency changes without user interaction.
- You need to have the AF function activated in order to use the RDS functionality and features.

DAB TUNER



Operation buttons

- | | |
|-----------------|---|
| 1. Home | Tap to open Main Menu. |
| 2. Back | Tap to return. |
| 3. Seek Down | Tap to select previous station of all stations (if SELECT settings is set to Ensemble).
Tap to select previous station of same ensemble / channel (if SELECT settings is set to Current).
Tap to select previous station of favourite list (if SELECT settings is set to Preset). |
| 4. Seek Up | Tap to select next station of all stations (if SELECT settings is set to Ensemble).
Tap to select next station of same ensemble / channel (if SELECT settings is set to Current).
Tap to select next station of favourite list (if SELECT settings is set to Preset). |
| 5. List | Tap to open list: Preset, Current, Ensemble. |
| 6. EQ | Tap to open EQ menu. |
| 7. SELECT | Tap to change skip button behaviour to Ensemble, current, Preset. |
| 8. Comfort Scan | Tap to start update scan. |
| 9. Full Scan | Tap to start full station search. |
| 10. DAB-FM | Tap enable/disable DAB-FM service following. |
| 11. DAB-DAB | Tap enable/disable DAB-DAB service following. |

- | | |
|---|--|
| A | Station name |
| B | Ensemble name |
| C | Slideshow picture of station if receivable |
| D | DSL text |

USB AUDIO

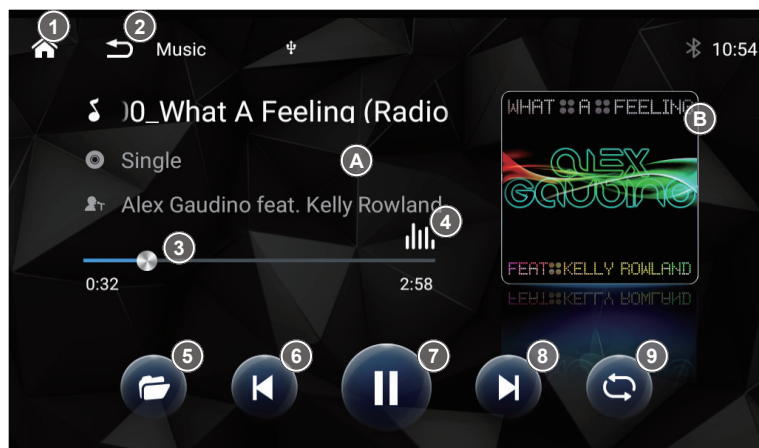

Operation buttons

- | | |
|------------------|---|
| 1. Home | Tap to open Main Menu. |
| 2. Back | Tap to return. |
| 3. Progress bar | Tap position to jump to. |
| 4. EQ | Tap to open EQ menu. |
| 5. List | Tap to open audio folder and file list. |
| 6. Seek Down | Tap to select previous track / file. |
| 7. Pause/resume | Tap to toggle pause and resume. |
| 8. Seek Up | Tap to select next track / file. |
| 9. Repeat/Random | Tap to toggle Repeat All, Repeat Single, Random Play. |

- | | |
|---|------------------------|
| A | Track information |
| B | Embedded cover of file |

USB VIDEO

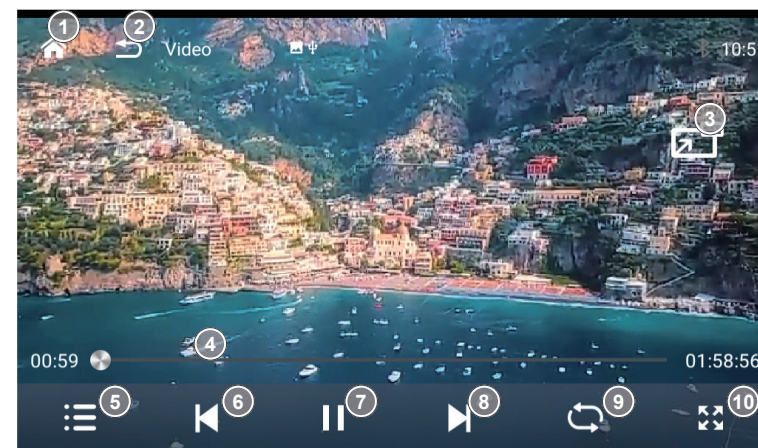

Operation buttons

- | | |
|--------------------|---|
| 1. Home | Tap to open Main Menu. |
| 2. Back | Tap to return. |
| 3. Floating Window | Tap to play in Floating Window. |
| 4. Progress bar | Tap position to jump to. |
| 5. List | Tap to open video folder and file list. |
| 6. Seek Down | Tap to select previous chapter / file. |
| 7. Pause/resume | Tap to toggle pause and resume. |
| 8. Seek Up | Tap to select next chapter / file. |
| 9. Repeat/Random | Tap to toggle Repeat All, Repeat Single, Random Play. |
| 10. Aspect Ratio | Tap to toggle the Aspect Ratio. |

Note:

- Please tap the touch screen to show the control bar from full screen.
Please follow the country specific laws and rules for video usage while driving.
A warning will be issued if the vehicle is not set to park mode.

X-527 features one camera input with switchable 12VDC power. The device will activate the camera power via 12VDC. Do not connect the camera power to a permanent power. To adjust the camera settings enter the main system settings > video.



The AUX-IN and HDMI source can be entered via the home screen icon. The source will provide you the AUX-IN or HDMI signal input to your XZENT device. There is no specific touch operation here besides the back to home screen button.

Operation Buttons

1. Return Press to return to the home screen.

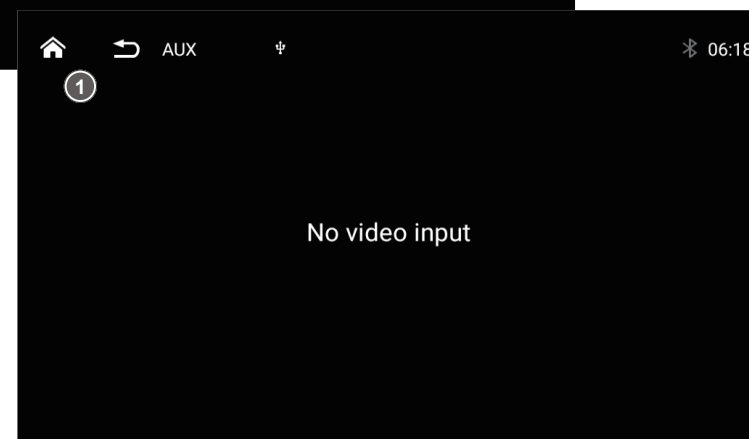
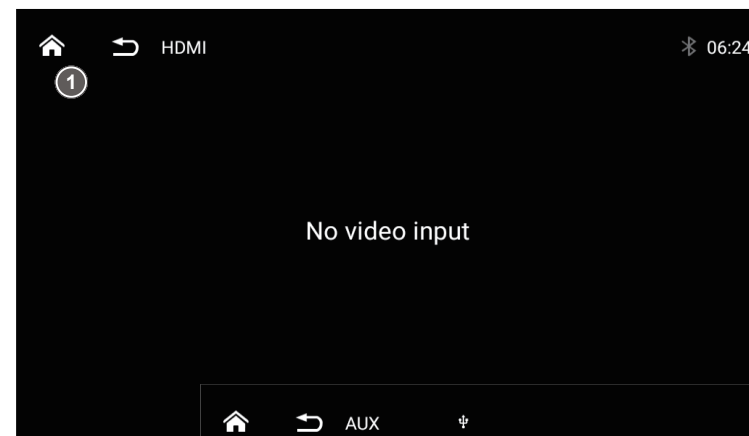

BLUETOOTH PHONE

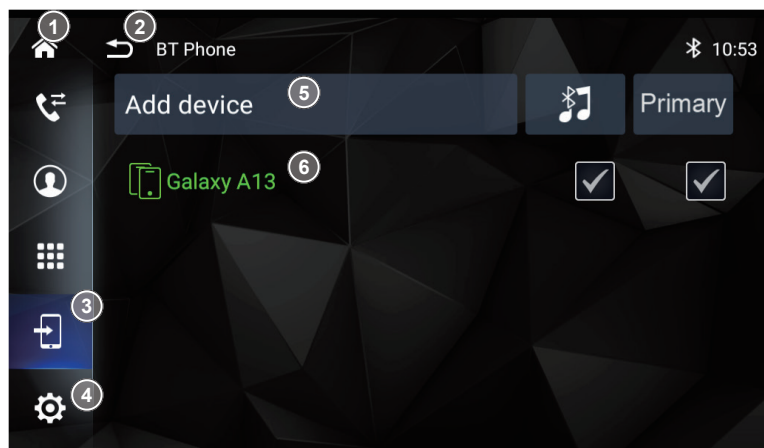

On first use, please perform a SCAN / SEARCH and make sure your phone is set VISIBLE. Select your phone from the result list and confirm the pass key to allow the unit to add your phone to the pair list.

Please ensure and confirm all required authorizations such as contact access / phone book access or other needed Bluetooth profiles. If you reject access, it may limit functionality.

Operation buttons

- | | |
|------------------|--|
| 1. Home | Tap to open Main Menu. |
| 2. Back | Tap to return. |
| 3. Scan / search | Tap to enter Scan / search menu. |
| 4. Settings | Tap to enter BT Settings menu.
Bluetooth: Tap to modify the unit's name.
Synchronize phone book: Tap to re-synchronize the phone book. |
| 5. Add device | Tap to search available Bluetooth devices. |
| 6. Device list | Tap to pair.
Long press a device's name in the list and tap [X] icon to delete it. |

BLUETOOTH PHONE



NOTE:

This source is the XZENT HFP telephony you need to connect a paired phone to use it.

If GAA or CarPlay is connected via USB, all telephony capabilities will be performed via the GAA or CarPlay and switch to their telephony mode.

Operation buttons

- | | |
|--------------|--|
| 7. Call log | Tap the open Call log list: Out calls, Received calls, Missed calls. |
| 8. Phonebook | Tap list item to perform out call. |
| 9. Keypad | Tap to open keypad. |
| 10. Dial | Tap to Dial out after input phone number. |
| A | Current paired phone name. |

BLUETOOTH MUSIC STREAMING

WIRING DIAGRAM

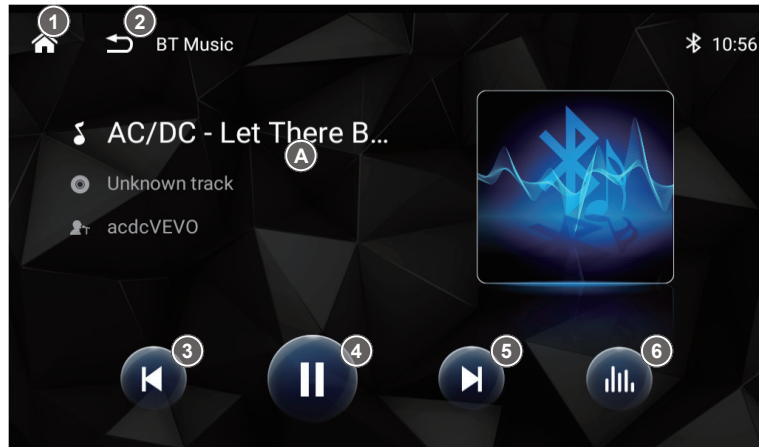

Operation buttons

- 1. Home Tap to open Main Menu.
 - 2. Back Tap to return.
 - 3. Seek Down Tap to select previous song.
 - 4. Pause/resume Tap to toggle pause and resume.
 - 5. Seek Up Tap to select next song.
 - 6. EQ Tap to open EQ menu.
- A Streaming information (depends on phone capability).

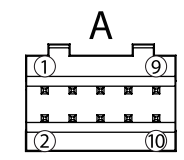
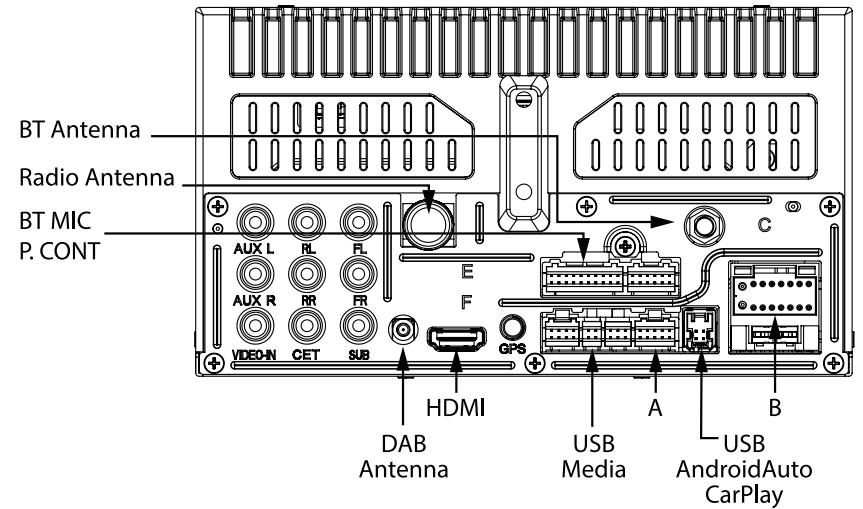

Pin No	Description
1	N/A
2	N/A
3	N/A
4	GND
5	IR-In
6	Camera CVBS
7	Camera +12V
8	GND
9	Parking
10	N/A

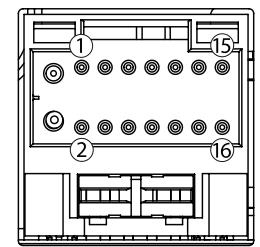

Pin No	Description	Pin No	Description
1	GND	9	FR-
2	B+	10	RL-
3	ACC	11	FR+
4	ILL	12	RL+
5	Reverse	13	FL-
6	N/A	14	RR+
7	N/A	15	FL+
8	P. ANT	16	RR-

TECHNICAL SPECIFICATION

VEHICLE COMPATIBILITY

Every vehicle with a 2-DIN mounting slot. Adapter cables and installation kit may be required (not included in the scope of delivery).

Electrical characteristics

Power supply: +12 V DC against vehicle ground
External protection against internal short-circuit: 15 A Mini-ANL fuse

Electrical characteristics*

ACC off idle status: < 4.3 mA
Audio / video playback (VOL 20): ~0.93 A
CarPlay or Google Androi Auto (VOL 20): ~1.40 A
CarPlay or Google Androi Auto (VOL 40): ~1.90 A

*@ 13.8 V operating voltage with front and rear 4 ohm loudspeaker connected to device

Transmitters (max. power)

Bluetooth module 100 mW

Transmitters (max. power)

Bluetooth module 2.4 Ghz

Radio Frequency Exposure Information

This device complies with EU requirements (2014/53/EU Article 3.1a) to limit exposure of the general public to electromagnetic fields for health protection.

Do not use the device in locations where wireless devices are not allowed.

XZENT cannot guarantee that accidents or damage will not occur due to improper use of the device. Use this product with care and at your own risk.

Recycling Notes



This product bears the symbol for selective sorting of Waste Electrical and Electronic Equipment (WEEE). This means that this product must be treated in accordance with European Directive 2012/19/EU in order to be recycled or dismantled to minimize its impact on the environment. The user has the choice to hand over his product to a competent recycling organization or to the retailer when a new electrical or electronic device is purchased.

Hereby, ACR Brändli + Vögeli AG declares that the type of radio equipment X-527 complies with the 2014/53/EU Directive. The full test of the EU Declaration of Conformity is available at the following internet address: www.xzent.com (see the link "Product Conformity Documents" in the footer of the page or scan QR code).

Hiermit erklärt ACR Brändli + Vögeli AG, dass der Funkanlagentyp X-527 der Richtlinie 2014/53/EU entspricht. Der vollständige Text der EU-Konformitätserklärung ist unter der folgenden Internetadresse verfügbar: <http://www.xzent.com> (siehe Link „Dokumente zur Produktkonformität“ im Fussbereich oder QR-Code scannen).

ACR Brändli + Vögeli AG déclare par la présente que le type d'équipement radio X-527 est conforme à la directive 2014/53/UE. Le texte complet de la déclaration de conformité UE est disponible à l'adresse Internet suivante: <http://www.xzent.com> (voir le lien "Documentation de conformité du produit" dans le pied de page ou scannez le code QR).

Con la presente, ACR Brändli + Vögeli AG dichiara che il tipo di apparecchiatura radio X-527 è conforme alla direttiva 2014/53 / UE. Il testo completo della Dichiarazione di conformità UE è disponibile al seguente indirizzo Internet: <http://www.xzent.com> (vedere il collegamento "Documenti di conformità del prodotto" nell'area a piè di pagina della pagina o scansiona il codice QR).



<https://secure.productip.com/public/view/file/id/1ed6f9?f=1ed6f9>

(E4) 10R-06 4977

Made in China



XZENT

XZENT by ACR AG · Bohrturmweg 1 · Bad Zurzach · Switzerland
www.xzent.com

EU Legal Representative: ACR S & V GmbH · Industriestraße 35 · D-79787 Lauchringen · Germany